

- 1) The tissue in plants that brings water upward from the roots;
- 2) a leading global water technology company.

We're 12,500 people unified in a common purpose: creating innovative solutions to meet our world's water needs. Developing new technologies that will improve the way water is used, conserved, and re-used in the future is central to our work. We move, treat, analyze, and return water to the environment, and we help people use water efficiently, in their homes, buildings, factories and farms. In more than 150 countries, we have strong, long-standing relationships with customers who know us for our powerful combination of leading product brands and applications expertise, backed by a legacy of innovation.

For more information on how Xylem can help you, go to www.xylem.com

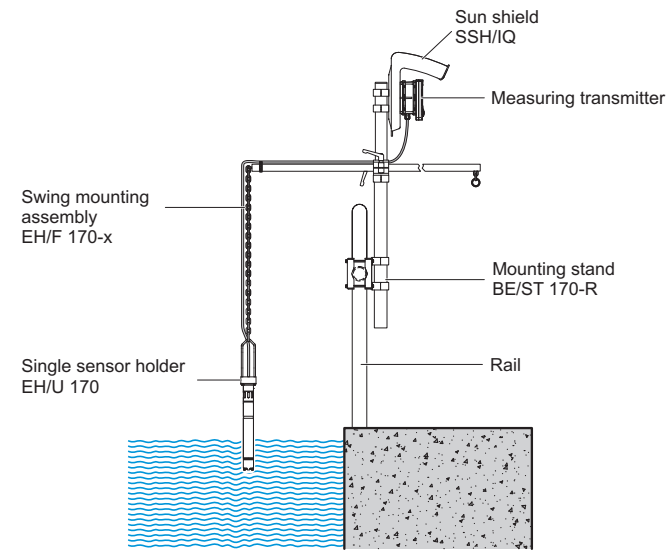

BE/ST 170-R

MOUNTING STAND (PIPE MOUNTING)



a xylem brand

YSI
1725 Brannum Lane
Yellow Springs, OH 45387
Tel: +1 937-767-7241; 800-765-4974
Fax: +1 937-767-1058
Email: environmental@ysi.com
Web: www.ysi.com

©Xylem Inc



a xylem brand

Assembly

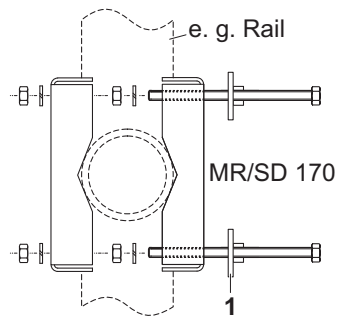

Mount the MR/SD 170 assembly set together with the weld-on-plates (1) to the rail, for example. (see MR/SD 170 assembly instructions)

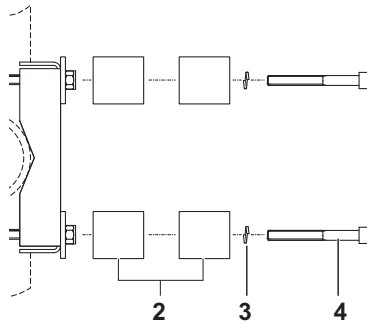

Loosely screw the aluminum clamp bodies (2) to the weld-on plates according to drawing.

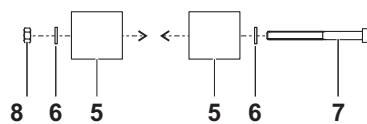

Loosely screw together two plastic clamp bodies (5) to form a holding clamp according to the drawing.

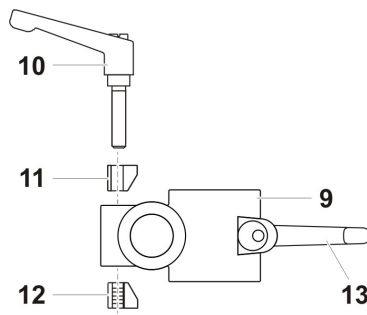

Preassemble the double junction clamp (9) according to the drawing.

Note: For the installation of additional EH/F 170-x swing mounting assemblies, additional double junction clamps (separately available as MS/KK 170) may be installed.

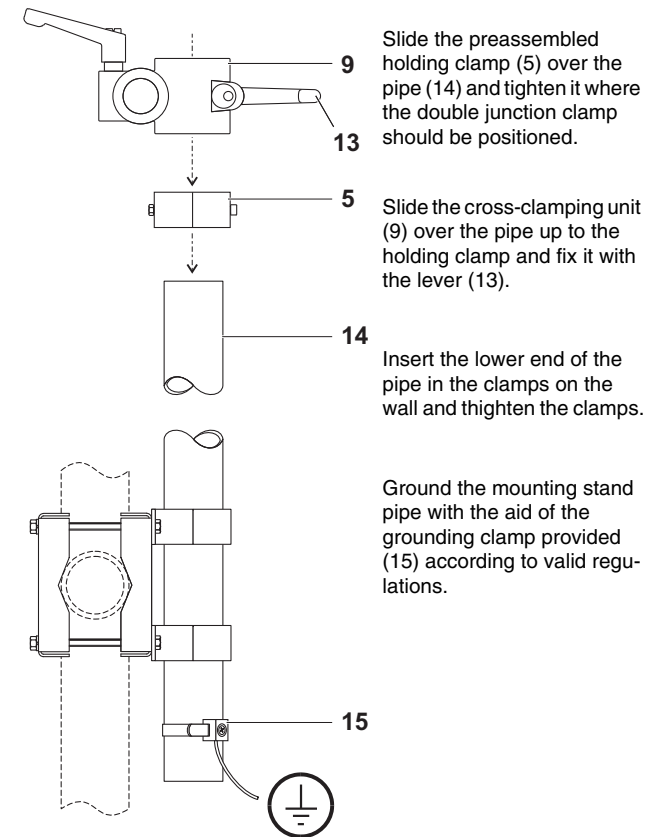

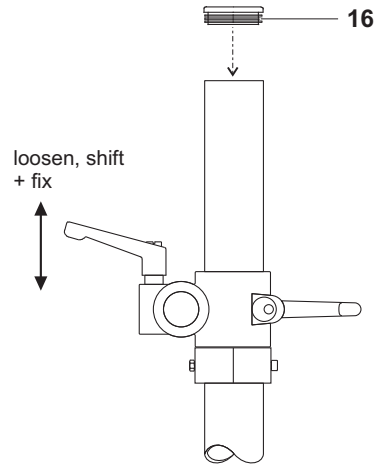

16
Close the upper end of the pipe with the lamellar plug (16).

To adjust the orientation of the lever, pull the lever, then turn and release.

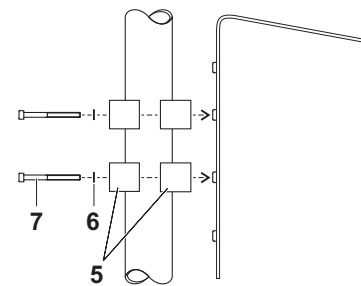

Mount the sun shield on the pipe using the four remaining plastic clamp bodies (5).

(The sun shield is not included in the scope of delivery)

Note on funktion:
Open the clamping lever only up to the point where the outrigger can be moved. If the clamping lever is unscrewed completely the wedges can get lost!

Technical data

Dimensions

| | |
|-----------------|--------|
| Column height | 970 mm |
| Column diameter | 50 mm |

Materials

| Pos. | Designation | Material |
|------|---------------------------------------|-------------------------------------------|
| 1 | Weld-on plate | Stainless steel 1.4301 (V2A) |
| 2 | Clamp body | Aluminum |
| 3 | Lock washer 6.1 | Stainless steel 1.4301 (V2A) |
| 4 | Hexagon socket head cap screw M6 x 60 | Stainless steel 1.4301 (V2A) |
| 5 | Clamp body | Polypropylene |
| 6 | Washer 5.3 | Stainless steel 1.4301 (V2A) |
| 7 | Hexagon socket head cap screw M5 x 60 | Stainless steel 1.4301 (V2A) |
| 8 | Nut M5 | Stainless steel 1.4301 (V2A) |
| 9 | Double junction clamp body | Aluminum alloy AISi12 |
| 10 | Clamping lever M8 x 40 | Zinc-base die-casting alloy, coated |
| 11 | Wege without thread | Stainless steel 1.4301 (V2A) |
| 12 | Wedge with thread | Stainless steel 1.4301 (V2A) |
| 13 | Clamping lever M8 x 50 | Zinc-base die-casting alloy, coated |
| 14 | Pipe | Stainless steel 1.4301 (V2A) |
| 15 | Grounding clamp | Bronze, tin-plated and steel, zinc-plated |
| 16 | Lamellar plug | Polyethylene (LD-PE) |